

03/05/23 9:56:29 AM D:\MY DOCUMENTS\RAILROAD\ELECTRICAL\BACHMANN\BACH S2 SPKR MOD BH1.DWG

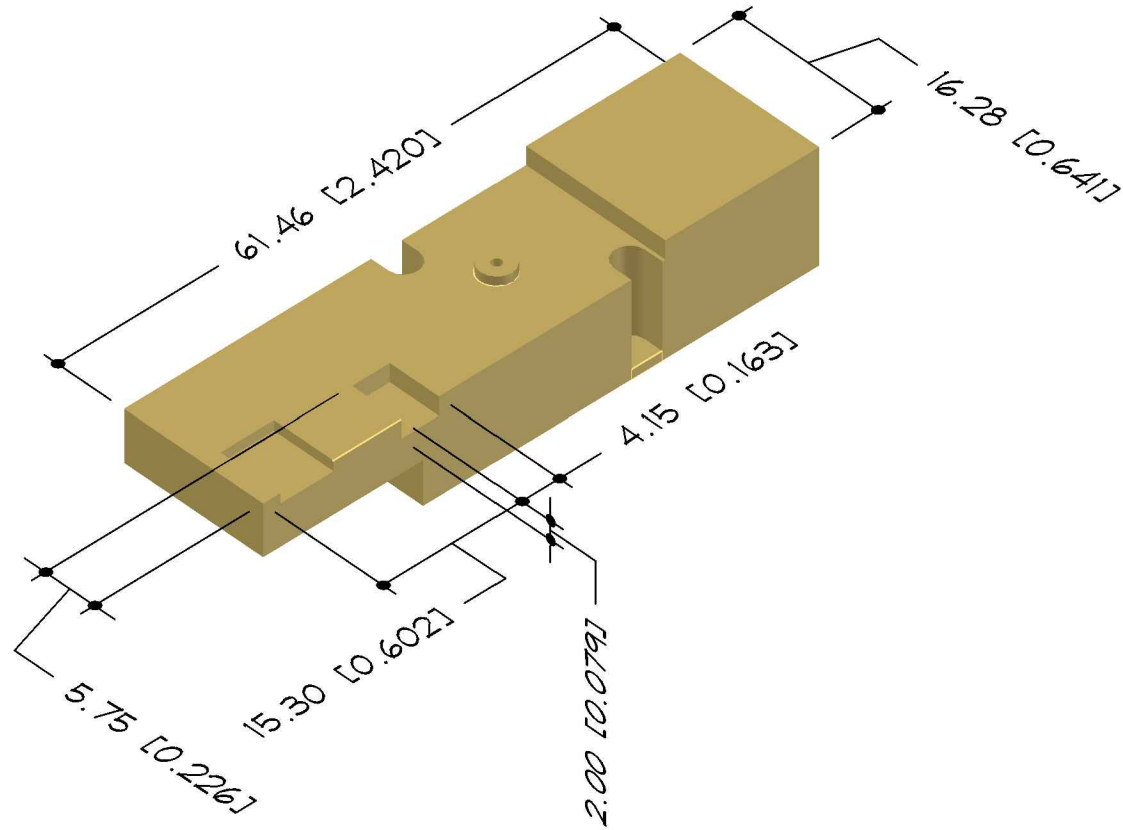

ADD NOTCH TO CLEAR SOUNDTRAXX	SCALE:N/A	PROJECT:ADD BH-1 TO S2	TITLE:ATLAS S2 SPEAKER MOD
CURRENT KEEPER CONNECTOR ON	DRAWN:JIM EXLER	LOC:NAMPA, ID	DRG: ATL S2 SPK
BH-1 DECODER (prev SOUND VALUE)	DATE: 3/5/23	JOB NO:823RR	Bach S2 Spkr mod BH1.dwg

REVISION
0